

54



 **AQUILA**

**54 YACHT POWER CATAMARAN**

# 54

## YACHT POWER CATAMARAN

The Aquila 54 Yacht Power Catamaran represents the reliable features and construction methods of the hundreds of Aquila yachts and boats cruising the waters of the world. This model enhances onboard luxuries with full-size refrigeration and layouts that include 3, 4, and 5-cabin options as well as skipper's quarters and galley down layouts.

Customization options are available to meet an assortment of boating lifestyles.





MERCURY

AQUILA



Integrated Entertaining Bar Connecting Social Areas





# PANORAMIC LUXURY





Wet Bar with Kenyon Grill and Corian Work Surface



Optional SkyLounge with Interior Stairs



Optional Captain Chairs

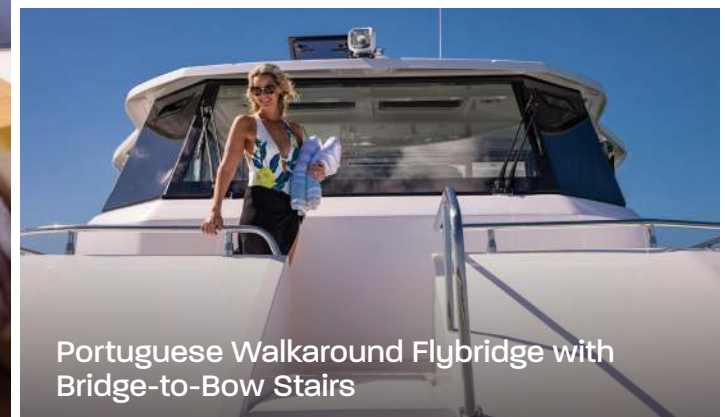

Portuguese Walkaround Flybridge with Bridge-to-Bow Stairs







**SUPERIOR  
QUALITY**







Salon with Convertible Dining Table

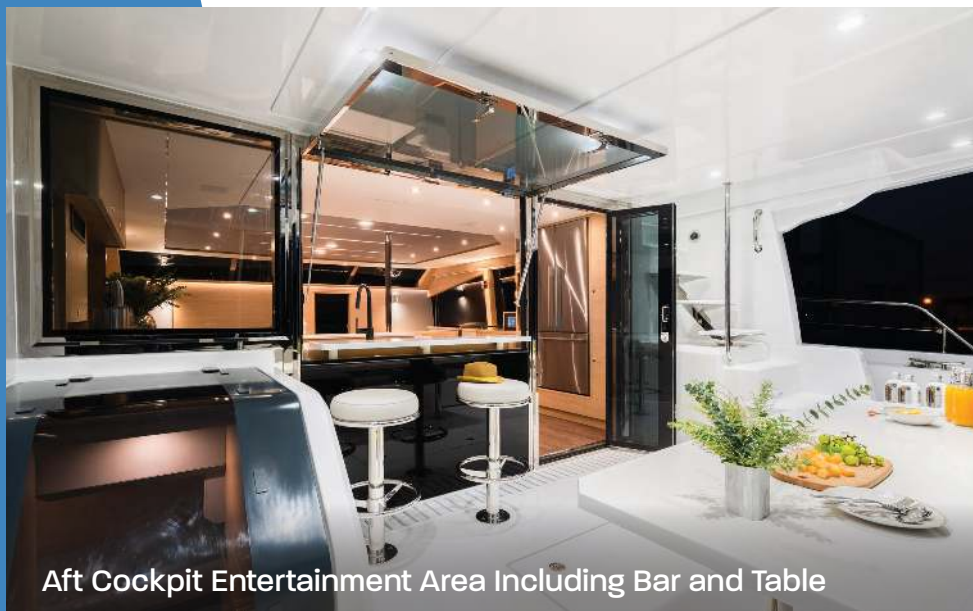

Aft Cockpit Entertainment Area Including Bar and Table



Large Double-Door Fridge and Freezer



Fully-Equipped Galley with Optional Dishwasher and Wine Cooler



# COMFORTABLE LIVING



14

AQUILA POWER CATAMARANS





Master Head with Electric Push Button Control



Portside Workstation and Walk-in Closet

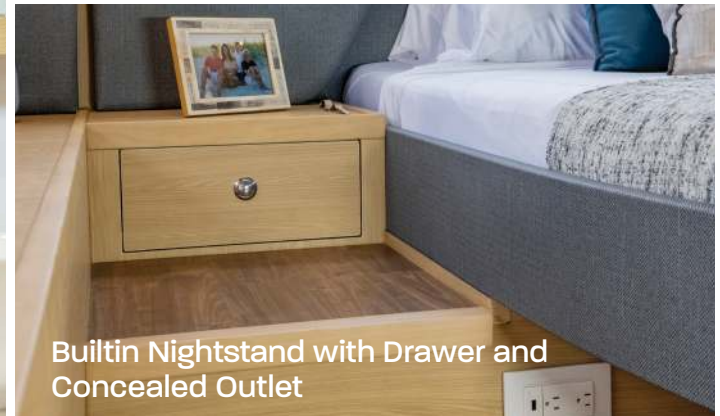

Builtin Nightstand with Drawer and Concealed Outlet



LED Reading Lights





Full-Beam Forward Master Cabin



VIP Portside Cabin with Generous Natural Light



Separate Shower Stall



VIP Head with Freshwater Flush Toilet



VIP Starboard Side Cabin



**QUALITY.  
INNOVATION.  
PERFORMANCE.**





AQUILA 54 YACHT POWER CATAMARAN



Secure Tender Storage



Optional Aquila 14' Catamaran RIB



Aquila Tender Lift System



Intelligent C-Zone Control



Bulbous Bows

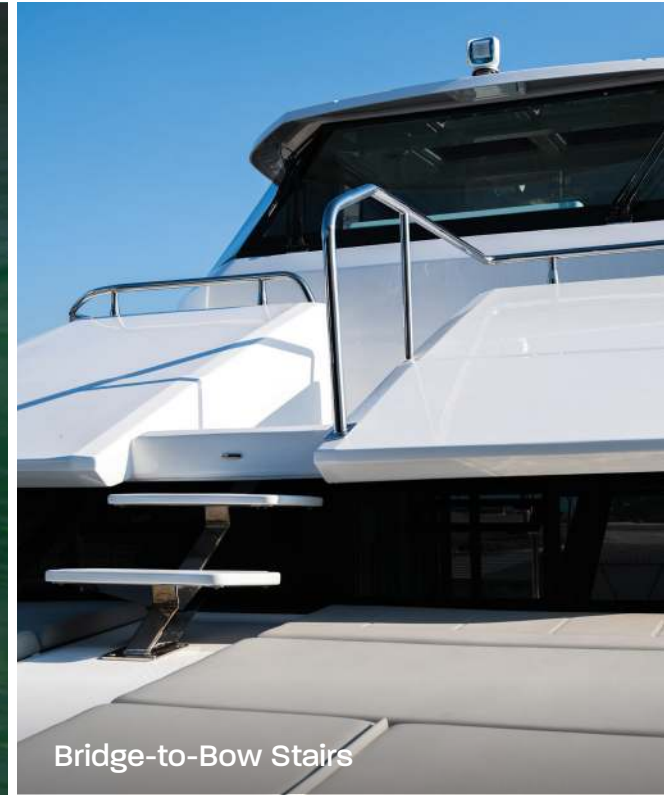

Bridge-to-Bow Stairs





AGUILA



**SPECIFICATIONS**

|   |                            |
|---|----------------------------|
| Length overall w/swim platform (exc. anchor roller) | <b>16.5 M / 54' 2"</b>     |
| Beam overall  | <b>7.68 M / 25' 2"</b>     |
| Height above waterline w/hard top, no electronics   | <b>6.15 M / 20' 2"</b>     |
| Height above waterline w/hard top, w/electronics    | <b>7.43 M / 24' 4"</b>     |
| Draft including propeller (depends on load)         | <b>1.37 M / 4' 6"</b>      |
| Fuel tank   | <b>2200 L / 581 GAL</b>    |
| Water tank  | <b>1000 L / 238 GAL</b>    |
| Holding tank  | <b>340 L / 90 GAL</b>      |
| CE certification                                    | <b>A (ocean):12 PAX</b>    |
|   | <b>B (offshore):12 PAX</b> |
|   | <b>C (coastal):20 PAX</b>  |
|   | <b>D (inland):30 PAX</b>   |

**Propulsion**

- 2 X D6-380HP VOLVO PENTA (STANDARD)**
- 2 X D6-480HP VOLVO PENTA (OPTIONAL)**
- 2 X 550HP CUMMINS QSB6.7 (OPTIONAL)**

*The specification measurements are approximate and subject to variance. Actual color samples may vary slightly from digital representation.*

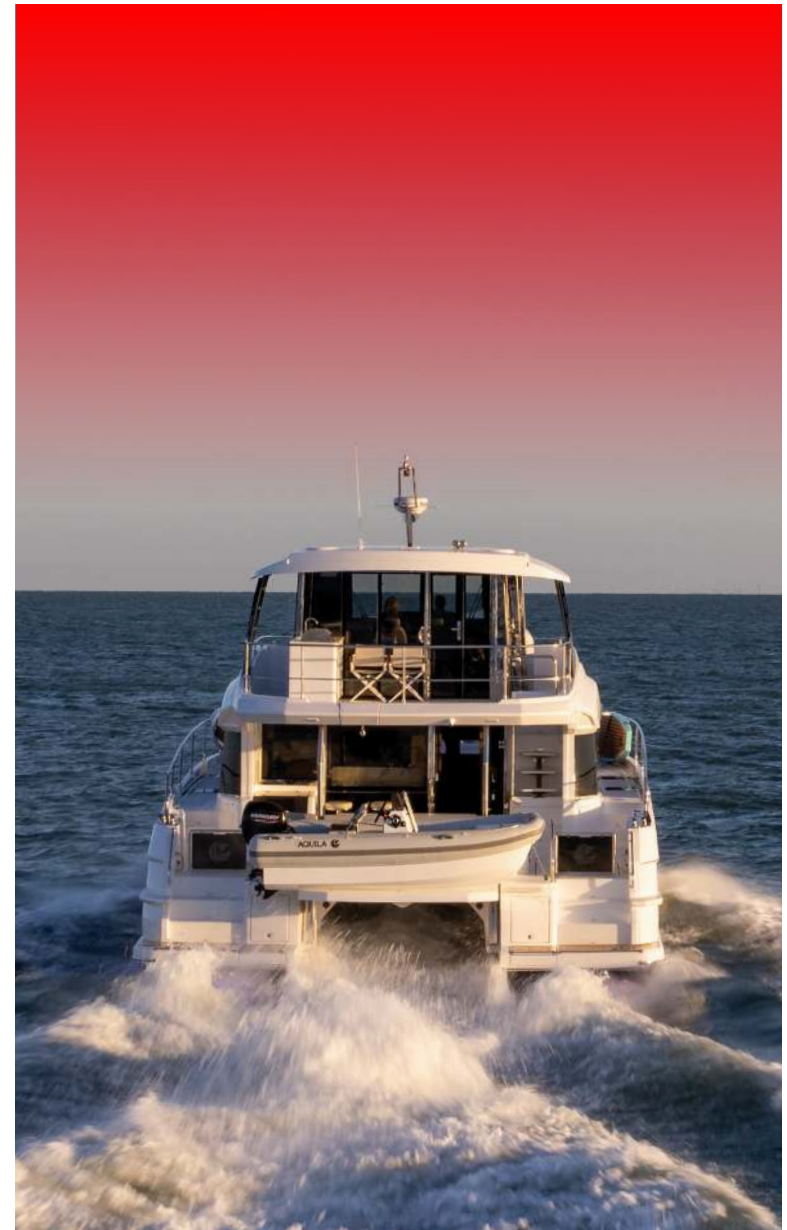

# 54

YACHT POWER CATAMARAN

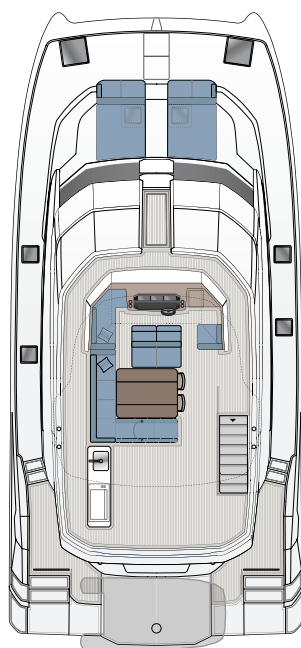

**STANDARD  
FLYBRIDGE**

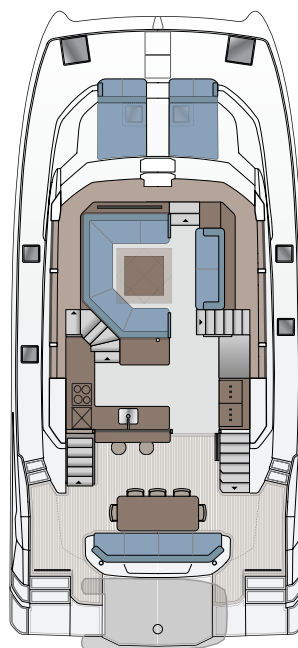

**STANDARD  
MAIN DECK**



**STANDARD  
3-CABIN**

# AVAILABLE DECK LAYOUT OPTIONS

## FLYBRIDGE OPTION

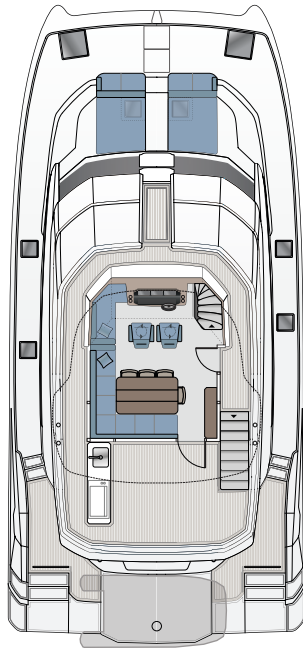

SKYLounge  
FLYBRIDGE

## MAINDECK OPTIONS

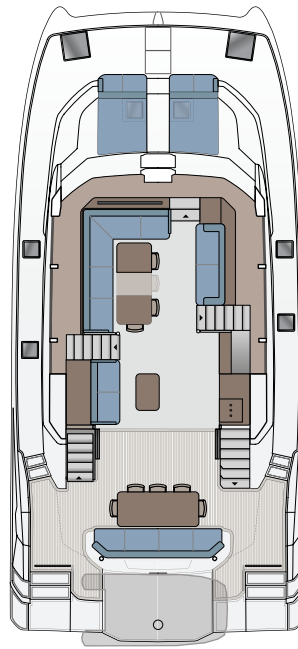

MAIN DECK  
GALLEY DOWN

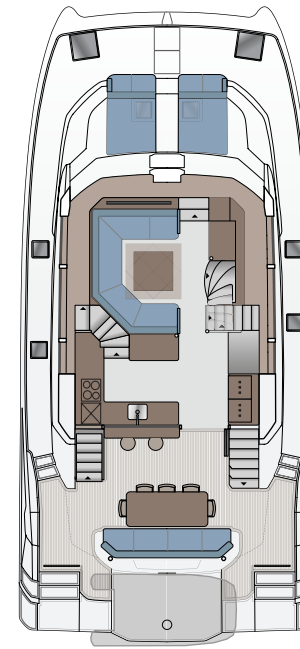

MAIN DECK  
GALLEY UP  
(SKYLounge FLYBRIDGE)

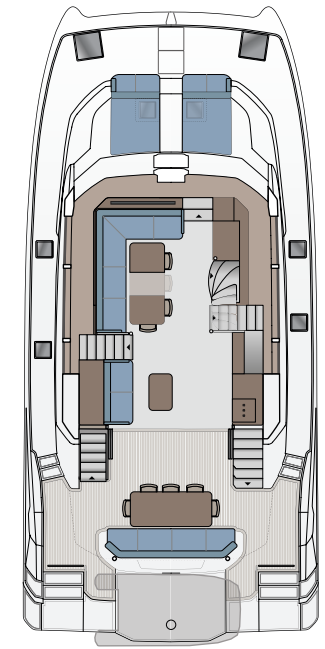

MAIN DECK  
GALLEY DOWN  
(SKYLounge FLYBRIDGE)

## CABIN OPTIONS

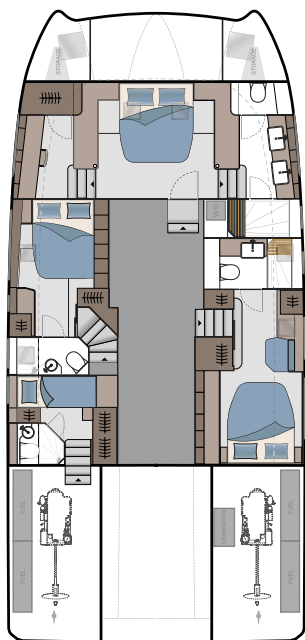

4-CABIN  
GALLEY UP

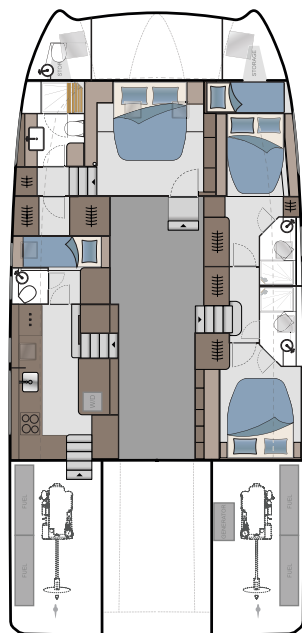

4-CABIN  
GALLEY DOWN

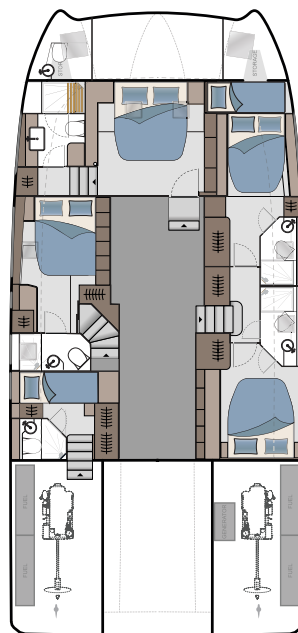

5-CABIN  
GALLEY UP





With over 40 years of manufacturing experience and the collaboration of multiple award-winning firms and designers, Aquila Power Catamarans is the recognized leader for innovation, quality, and performance in this growing category of pleasure boats.





 **AQUILA**  
aquilaboats.com

Copyright © 2023 Aquila Boats. All rights reserved.