

**X**  
CLASS





EXPERIENCE THE  
EXCEPTIONAL

Your yacht is an extension of yourself. A statement of your lifestyle. She needs to deliver unforgettable experiences for you, your family and friends. Every Princess yacht is designed with our forward-thinking mentality and crafted with meticulous attention to detail. So whether you're dashing across the water or moored in your favourite bay, you will recognise the difference our design and details make, inside and out.

Experience the exceptional.



## CRAFTED IN PLYMOUTH

Perched on the edge of the English Channel lies the city of Plymouth, where we established our home in 1965. Today Princess shipyards cover an area of over 1.1 million square feet, an area rich in British maritime heritage. In fact, South Yard, where our X Class Super Flybridge yachts are constructed, is a former naval yard dating back to the 17th century. From the outset, our goal has been to meticulously sculpt our yachts around our owners' enjoyment of them. Such dedication and attention to detail resonates deeply with our Plymouth craftspeople.

Over 3,000 people, each possessing a mastery of their skill, fastidiously realise this vision in our shipyards. Through a culture of innovation, our yachts are not only some of the most technically-advanced in the world but also the most beautifully realised.



## DESIGNED FOR A LIFE LESS ORDINARY

Elegantly fusing architectural innovations with all the craftsmanship qualities you can expect from Princess, X Class is unique. Designed in collaboration with the winning combination of Olesinski and Pininfarina, X Class yachts set a new standard of layout excellence. Large adaptable spaces can be formatted in numerous ways, offering the owner and guests a uniquely flexible boating lifestyle. This 'open concept' delivers 10% more outdoor space and 40% more indoor space than a traditional motor yacht.



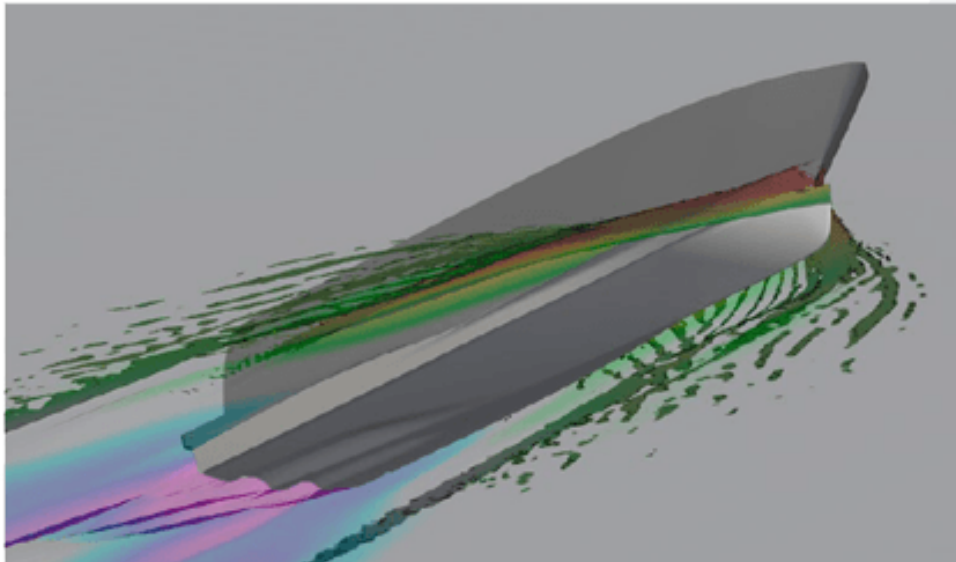
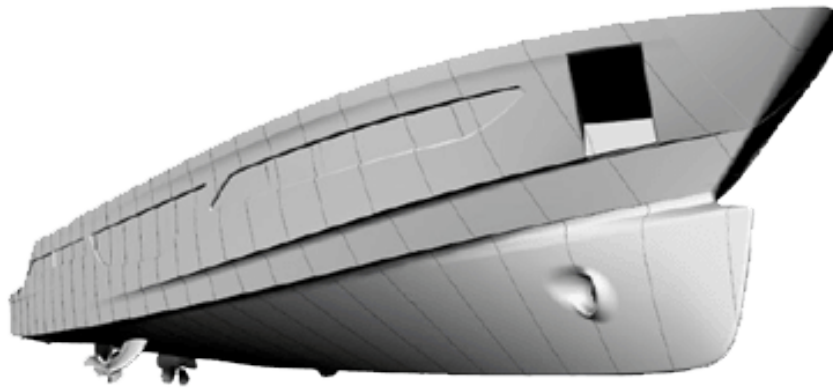

## TECHNOLOGY FOR THE POWER TO EXPLORE

Already synonymous with developing hulls that deliver excellent sea-keeping, our X Class is no exception. In fact it's a giant leap forward in stability in all sea conditions and a 15% improvement in efficiency compared with traditional hull designs. To achieve this, machine learning methods were applied to computational fluid dynamics results to transform the well-proven qualities of our deep V hull. Efficiency across the speed range improved whilst maintaining the highest levels of sea-keeping and predictable handling. The wave-piercing bow extends the waterline forward, providing a fine, high deadrise entry. The benefits of this bow shape are further enhanced by extended hull surfaces aft under the bathing platform. These hulls will transition smoothly from highly efficient low



## X CLASS

Experience an entirely new concept in yacht design - Super Flybridge yachts that completely rethink yacht architecture to set a new benchmark for luxury living space. Our new X Class is the perfect craft for those who wish to spend extended time aboard and voyage further afield.



X 95





Characterised by beautifully sculpted surfaces and long flowing lines, the X95 defines a striking design language for this new Class. Both her flybridge and main deck cover almost the full length of the yacht, delivering expansive spaces with flexibility that enables you to define each journey around your guests' preferences. With a fuel capacity of 13,400 litres, the X95 has the range for far-reaching, adventurous voyages.





Experience superyacht-space as you enter her main deck saloon and witness a line of sight right through to the forward window. Ascend the internal staircase to the upper deck and another unique experience awaits: a fully enclosed and climate-controlled sky lounge. Taking pride of place on her lower deck is the full beam master stateroom with en suite, complemented by her forward stateroom with walk-in wardrobe and en suite bathroom. Additional port and starboard guest cabins can each be configured with two single beds or an electrically-converting double bed, whilst generous crew quarters complete her extensive accommodation.





EXPERIENCE THE X95





TAKE A VIRTUAL TOUR OF THE X95





**X95**  
SPECIFICATION





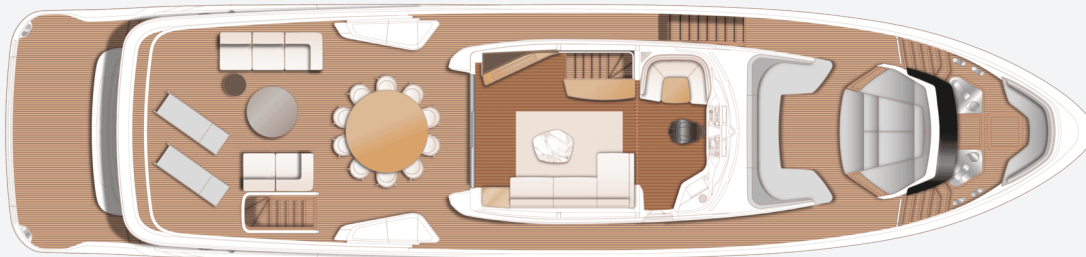

X95 Flybridge

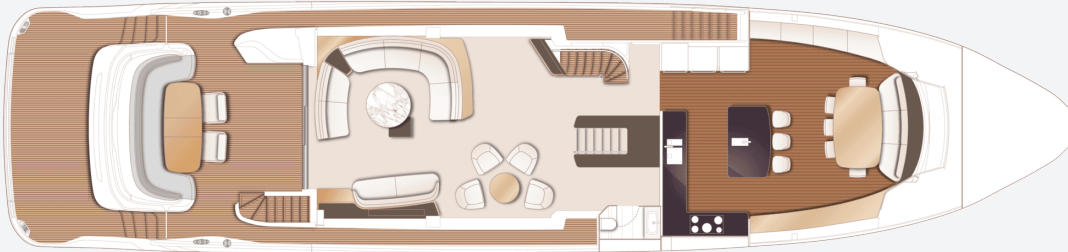

X95 Main Deck

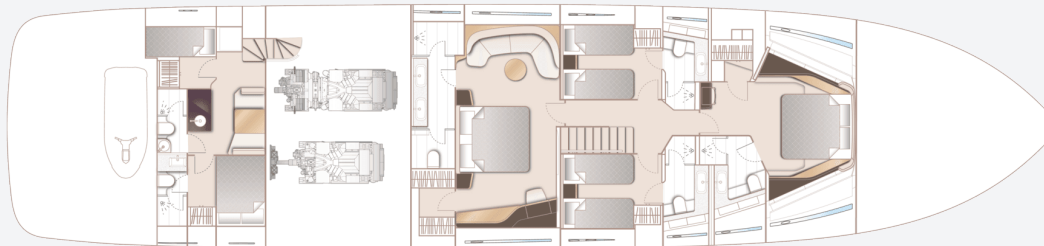

X95 Lower Deck

PRINCIPAL DIMENSIONS

<b>Length overall (incl. pulpit)</b>	95ft 4in (29.0m)
<b>Length overall (excl. pulpit)</b>	95ft 4in (29.0m)
<b>Beam</b>	21ft 10in (6.65m)
<b>Draft approx. (full load)</b>	6ft 8in (2.03m)
<b>Displacement approx. (half load)</b>	112,409kg (247,819lbs)*
<b>Fuel capacity</b>	3,040 gal/3,650 US gal/13,818l
<b>Water capacity (excl. calorifier)</b>	410 gal/492 US gal/1,865l

ENGINES

<b>Twin MAN V12-1900 (2 x 1,900mhp)</b>	Speed range: 21-23 knots†
---	------------------------------

## FULL SPECIFICATION

---

### DECK FITTINGS

- 6mm teak-laid transom platform, transom steps, cockpit deck, stairway to flybridge, side decks, steps to foredeck, flybridge aft sun deck and foredeck lounge walkthrough areas
- Reversible hydraulic anchor winches with bridge controls (Lewmar V8)
- Anchor pockets with anchor launch and retrieve
- Twin anchor system incorporating two 125kg galvanised kedge anchor with 100m of 14mm galvanised chain
- Deck chain stoppers (2)
- Mooring bollards forward (4)
- Mooring bollards aft (4)
- Mooring bollards on platform cheeks (2)
- Mooring bollards mid-ship (1 per side)
- Twin electric sternline mooring winches (Lewmar C6)
- Deck hatch access to chain, Bosuns and fender storage locker (non-locking, with access ladder)
- Freshwater deck/anchor wash (with both fore and aft deck outlets) (under bow seat, starboard side outboard of transom steps) (quick release bayonet fitting)
- Stainless steel bow and stern fairleads
- Stainless-steel foredeck guard rails
- Stainless steel flybridge handrails
- Stainless gates (with glazing) to restrict access to the foredeck area
- PVC rubbing band with stainless-steel insert
- LED deck level lighting
- Full set of IMCO navigation lights
- Riding light
- Twin beam searchlight with remote controls (located on mast)
- Loudhailer (located on hardtop)
- Stern docking lights (on underside of canopy/flybridge overhang)
- Twin electric horns (located on mast)
- Fuel and water fillers (fuel: main deck, port and starboard, water: port side)
- Upholstered U-shaped seating with storage below (non-locking)
- Teak dining table with removable central leaf section paired with 2 dining chairs
- LED overhead and deck level lighting
- Stainless-steel handrails (round top profile)
- Stern docking station controls portside including thruster controls and emergency engine stop, Rexroth control as standard
- Remote control 5.47m telescopic passarelle with folding handrails
- Watertight (double D sealed) hinged locking door giving access from transom into garage / optional beach club area
- Engine room to cockpit escape hatch
- Crew area escape hatch to cockpit
- Garage (to take wetbike up to 3.05m) with electro-hydraulic door with additional storage for optional SEABOBs (2 max, starboard bulkhead mounted rack)
- Rope storage locker (non-locking)

### COCKPIT AND BATHING PLATFORM

- Self-draining

- Wash basin with mixer tap to portside
- Starboard locker containing remote fuel cocks, manual bilge pump with valve chest and manual controls for automatic fire extinguishers
- Integral stairway to flybridge with teak step treads
- Twin glazed transom gates leading to bathing platform
- Electro-hydraulic teak-laid transformer bathing platform (1,000kg SWL)
- Retractable bathing ladder (manual) in side of bathing platform
- Hot and cold transom shower
- Three phase shore support inlet (380v-415v / 42kVa @50Hz) with Glendinning cabling (15m/50ft) and a single phase shore power inlet (220-240v / 15kVa @ 50Hz. Both shore supports with isolation transformers. (US Spec single phase 2 x 100A)
- Seat and table covers
- Port side deck lockable access and stairway to crew accommodation

#### **HELM**

- Enclosed pilot house with central leather upholstered electric seat with fore, aft and

height adjustment

- U-shaped companion seating to port with table
- Sliding doors to fully enclose or open helm to skylounge area
- Instrument console with LED display incorporating engine instruments, CCTV linked to Böning screens, fuel gauges, alarms and rudder position indicator
- Helm position instrument and controls console including:
  - power-assisted electro-hydraulic steering (SeaStar)
  - adjustable steering wheel
  - high-speed magnetic compass
  - electronic engine controls
  - bow thruster control
  - hydraulic anchor winch remote control
  - colour radar (with scanner) and GPS/chart plotter (twin 19" displays)
  - autopilot
  - speed and distance log
  - echo sounder with alarm
  - VHF with DSC R/T with intercom
  - remote control dual searchlight
  - horn button (to operate twin electric horns)
  - audible and visual alarm for bilge pumps

- engine room fire extinguisher warning system
- Automatic fog horn with loudhailer
- Chart storage
- Drink holders
- Toughened glass screen (clear for night vision) with windscreen de-mist system
- Windscreen wipers with freshwater windscreen wash
- Exterior black mesh windscreen covers
- Bilge pump controls with visual pump running warnings
- 24v and 240v electrical control panel
- Riding light, helm and navigation light control switches
- USB charging points (2)
- Dimmable LED overhead, concealed (24v) and night lighting with scene selection
- Watertight pantograph door giving direct access from starboard side deck
- Electric drop window to port
- Timber flooring (V groove planked)

#### **SKY LOUNGE**

- L-shaped sofa, coffee table and pouf
- 55" 4K UHD LED TV on rise and fall
- DVD Blu-ray system with Naim Uniti Atom audio

- system speakers (2)
- Sideboard with fridge and storage
- Access stairway to main deck
- Stainless steel opening glass doors to aft deck area
- USB charging points (2)
- Dimmable LED overhead and concealed lighting (24v) with scene selection
- Tinted panoramic toughened side windows
- Glazed roof panels with powered blinds
- Electric blinds to all side windows
- Timber flooring (V groove planked) with rug inlay

#### **FLYBRIDGE AND FOREDECK**

- Foredeck area with U-shaped seating, and storage locker
- Foredeck to incorporate glazed panels to allow light through to galley / dining area or optional main deck owner's stateroom below
- Sunbathing area with integrated adjustable teak headrests and storage, converts to aft facing u-shaped seating area.
- Flybridge aft deck area with free standing furniture
- Dining table with chairs to accommodate 8

- persons (10 for optional 5 cabin layout)
- Naim Uniti Atom audio system with waterproof speakers (2) to flybridge
- Clear view hatch to aft cockpit
- Access stairway to aft cockpit
- Stainless-steel handrails with glass balustrade to aft and sides of flybridge deck
- Starboard storage/servery unit, incorporating liferaft stowage and deck wash outlet
- Port storage/servery unit with sink and tap, incorporating liferaft stowage
- LED overhead and deck level lighting
- Radar mast
- Twin matching whip aerials for VHF R/T and radio
- Covers to exterior furniture

#### **SALOON**

- Large curved sofa to port with storage below
- Curved sofa to starboard with storage below
- Coffee table with pouf
- 65" 4K UHD LED TV on rise and fall.
- Naim audio system with speakers (4) and subwoofer
- Servery unit with integrated drinks refrigerator, bottle storage and icemaker (located on port

- side forward of saloon)
- Occasional coffee table with four armchairs to starboard
- Full height glazing port and starboard in way of servery unit/bar and starboard free standing seating areas
- Panoramic tinted toughened glass windows port and starboard
- Triple stainless steel framed cockpit doors
- Watertight side hinge door to starboard side deck
- Access stairway to lower accommodation
- Access stairway to skylounge
- Dimmable LED overhead and concealed lighting with scene selection
- 220/240v outlets (4)
- USB charging points (2)
- Electric roller blinds to outboard windows
- Manual curtains on wave track to aft patio doors
- Fitted carpet

#### **GALLEY**

- Open layout / country kitchen with forward dining area
- Galley and island unit counter top in choice of granite or quartz

- Miele 5 zone induction hob
- 900mm wide conventional oven
- Miele Combination convection/microwave oven with grill
- Twin full height refrigeration units with deep freeze drawers
- Island unit/breakfast bar with triple stainless steel sinks, 12 place dishwasher, storage and space for optional drawer fridge
- Barstools (3)
- Waste bin
- High and low level storage cupboards and drawers
- Extractor fan
- Space for optional wine cooler
- Access to deck saloon
- Watertight pantograph access door to port side deck (in forward saloon)
- 220/240v power outlets (4)
- Dimmable LED overhead and concealed lighting with scene selection
- Electric blinds to windows
- Timber flooring (V groove planked)

#### **DINING AREA**

- Dining table with aft facing fixed seating and

- dining chairs (5)
- Port sideboard bench unit with upholstered top
- Sideboard units (2) with crockery, glassware and general storage
- Entertainment unit with Naim Uniti Atom audio system and speakers (2)
- Ice maker
- Cutlery and crockery storage (in port side staircase unit)
- 220/240v power outlets (2)
- USB charging points (4)
- Dimmable LED overhead and concealed lighting (24v) with scene selection
- Panoramic tinted toughened glass windows port and starboard
- Powered blind to forward glazing
- Electric roller blinds to windows
- Timber flooring (V groove planked)

#### **DAY HEAD**

- Electric freshwater toilet
- Wash hand basin and counter top in thermoformed solid surface
- Storage cupboard
- Manual tension venetian blind
- Marble/granite/quartz floor

#### **ACCOMMODATION**

- All cabins and bathrooms feature opening portholes and air conditioning
- All cabins feature 220/240v powerpoints
- All en-suites feature 240v shaver points

#### **OWNER'S STATEROOM**

- Large double bed with bedside tables and drawers below
- Dressing area with full length mirror, hanging, shelf and drawer storage
- Built-in safe
- Starboard dressing table with integrated mirror, chair, storage drawers and cupboards
- Portside sofa with storage below and coffee table
- 55" 4K UHD LED TV
- Naim audio system with speakers (2) and subwoofer
- Panoramic windows including opening portholes
- Electric roman blinds to hull windows, with outboard manual sheer roller blind
- Dimmable LED overhead and concealed lighting (24v) with scene selection
- Wall lights (2)

- 220/240v outlets (4)
- USB connection points (4)
- Fitted carpet

#### **EN-SUITE BATHROOM**

- Twin washbasins and counter top in thermoformed solid surface
- Mirror
- Storage lockers
- Separate compartment with toilet and option of combination toilet/bidet
- Shower compartment with automatic pump out
- Extractor fan
- Window with opening porthole
- Manual tension venetian blind
- LED overhead and concealed lighting (24v)
- Bathroom accessories
- Marble/granite/quartz to floor and specified bulkheads

#### **FORWARD STATEROOM**

- Large double bed with drawers below
- Walk-in wardrobe with shelves
- Dressing table with stool
- Mirror
- Storage lockers

- 43" UHD LED TV
- Naim Atom audio system with ceiling mounted speakers (2)
- Windows with opening portholes
- Electric roman blinds to hull windows
- LED overhead and concealed lighting (24v) with scene selection
- Wall lights (2)
- 220/240v outlets (2)
- USB charging points (4)
- Fitted carpet

#### **EN-SUITE BATHROOM**

- Washbasin and counter top in thermoformed solid surface
- Mirror
- Storage lockers
- Shower compartment with automatic pump out
- Extractor fan
- Window with opening porthole
- Manual tension venetian blind
- LED overhead and concealed lighting (24v)
- Bathroom accessories
- Marble/granite/quartz flooring

#### **STARBOARD GUEST CABIN**

- Two single beds with drawers below (with option of double bed conversion)
- Bedside table
- Wardrobe with lower shelves
- Mirror
- Storage lockers
- Window with opening portholes
- Electric roman blinds to hull windows
- Dimmable LED overhead and concealed lighting (24v) with scene selection
- Individual berth lights
- 220/240v outlets (1)
- USB charging point (2)
- Fitted carpet

#### **EN-SUITE BATHROOM**

- Washbasin and counter top in thermoformed solid surface
- Mirror
- Storage lockers
- Shower compartment with automatic pump out
- Extractor fan
- Windows with opening porthole
- Manual tension venetian blind
- LED overhead and concealed lighting (24v)
- Bathroom accessories

- Marble/granite/quartz flooring

#### **PORT GUEST CABIN**

- Two single beds with drawers below (with option of double bed conversion)
- Bedside table
- Wardrobe with shelves
- Mirror
- Storage lockers
- Window with opening portholes
- Electric roman blinds to hull windows
- Dimmable LED overhead and concealed lighting (24v) with scene selection
- Individual berth lights
- 220/240v outlets (1)
- USB charging point (2)
- Fitted carpet

#### **EN-SUITE BATHROOM**

- Washbasin and counter top in thermoformed solid surface
- Mirror
- Storage lockers
- Shower compartment with automatic pump out
- Extractor fan
- Windows with opening porthole

- Manual tension venetian blind
- LED overhead and concealed lighting (24v)
- Bathroom accessories
- Marble/granite/quartz flooring

#### **LOWER ACCOMODATION LOBBY / PASSAGEWAY AREA**

- Linen cupboard below companionway stairs
- Space for optional washer/dryer below companionway stairs
- Dimmable LED overhead and concealed lighting (24v) with scene selection
- Fitted carpet

#### **CREW QUARTERS**

- Standard transom configuration is a transom garage with Captain's double cabin with en-suite, crew bunk cabin, aft bathroom, crew mess and dining area.
- Optional transom configuration is a beach club with Captain's double cabin - with en-suite, crew bunk cabin, central bathroom and aft beach club/ dining area.
- (N.B. All lower crew furniture is in white finish, with solid surface Carrera white (gloss finish) bathroom vanity unit tops and solid surface

Koko white (satin finish) bathroom floors and non-slip flooring)

#### **CAPTAIN'S CABIN**

- Double berth with storage below
- Wardrobe with shelf
- Mirror
- Storage drawers under bunk
- Opening porthole and venetian blind
- Emergency deck hatch access to cockpit
- LED overhead lighting (24v)
- Individual berth light
- 220/240v outlets (1)
- USB charging points (2)
- Fitted carpet

#### **CAPTAIN'S EN-SUITE**

- Washbasin with Carrera White (gloss finish) solid surface counter top
- Mirror
- Storage lockers
- Shower compartment with automatic pump out
- Extractor fan
- Porthole with venetian blind
- LED overhead lighting (24v)
- Bathroom accessories

- Solid surface flooring in Koko white (satin finish)

#### **PORT CREW CABIN**

- Single bunk beds (2)
- Wardrobe with shelf
- Mirror
- Storage lockers
- Opening porthole and venetian blind
- LED overhead lighting (24v)
- Individual berth lights
- 220/240v outlets (2)
- USB charging points (2)
- Fitted carpet

#### **CREW BATHROOM**

- Washbasin with Carrera white (gloss finish) solid surface counter top
- Mirror
- Storage lockers
- Shower compartment with automatic pump out
- Extractor fan
- Porthole with venetian blind
- LED overhead lighting (24v)
- Bathroom accessories
- Solid Surface flooring in Koko white (satin finish)

#### **CREW AREA**

- Access from port side deck (also transom door with optional beach club)
- Access to engine room
- Storage space, cupboards and lockers
- Dining area with table
- Crew mess with microwave with grill, sink, refrigerator and waste bin
- Solid surface counter top in Ice Crystal (satin finish)
- Washing machine and separate tumble dryer
- LED overhead lighting (24v)
- Non-slip flooring

#### **POWER AND DRIVE SYSTEMS**

- Engine room soundproofed
- High volume air intakes
- Engine room extractor fan with electronic time delay
- Engine exhaust silencers and water-cooled exhausts
- Engine beds integrally moulded with hull for strength and vibration absorption
- Forward and aft engine room bulkheads integrally bonded including acoustafoam layers
- Engines flexibly mounted

- Automatic fire extinguisher with remote override control
- Automatic and manual bilge pumps
- Propeller shafts in Marinemet
- 5-bladed propellers in nickel aluminium bronze
- High speed balanced rudders
- Cathodic protection for sterngear
- Sterngear, engines, fuel tank fillers, all electrically bonded
- LED engine room lighting
- Engine room access from port side deck via crew area and from cockpit deck
- Power-assisted electro-hydraulic steering system
- Electronic engine and gear shift controls
- Bow thruster with dual-station controls ( 550kgF)
- Fresh water supply point in engine room
- Dripless self-aligning shaft seals

#### **ELECTRICAL SYSTEMS**

24 Volt:

- 4 x heavy duty batteries for engine starting
- 6 x heavy duty auxiliary batteries
- Battery link facility with remote control at helm position



- Both battery banks are charged using a voltage sensitive relay that parallels both battery banks when a charging source is present
- 1 x 100 amp charger, 1x 100 amp-3500W charger/inverter & 1x 25 amp charger (for generator battery).
- Remote battery isolator control switches at main switch panel position
- Circuit breakers on all circuits
- 24v to 12v converters for certain navigation and radio circuits
- Galvanic isolation system
- CCTV system with camera in aft cockpit and two fixed cameras in engine room linked to Böning system

220/240 Volt:

- European specification: 2 x 40kW @ 50Hz Onan diesel generators in own sound shields, water cooled and with specially silenced exhaust systems and with remote operation from main control panel
- USA specification: 2 x 40kW @ 60Hz Onan diesel generators in own sound shields, water cooled and with specially silenced exhaust systems and with remote operation from main

control panel

- Three phase shore inlet (380v-415v / 42kVA @50Hz) with Glendinning cablemaster (15m/50ft) and a single phase shore power inlet (220-240v / 15kVA @ 50Hz. Both shore supports with isolation transformers. (US Spec single phase 2 x 100 amp)
- Shore power/generator change over control operated from main control panel
- Polarity check system
- Earth leakage safety trip, circuit breakers on all circuits
- Power points (240v) in all cabins and living areas, helm position and galley
- 240v shaver points in washrooms
- 3kW immersion heater for fresh water (2)

#### **FUEL SYSTEM**

- Main fuel tank with fuel polishing transfer system to day tank giving a total 13,818 l of fuel capacity (forward fuel bunker tank 4,866l and main fuel bunker tank 8,008l plus day fuel tank 944l)
- Fuel fillers to port and starboard
- High capacity duplex fuel filters/water traps with integral changeover valves and water

- sensors connected to alarms at helm position
- Remote fuel isolation controls in cockpit locker for main engines and generators
- Fuel gauges at helm position

#### **AIR CONDITIONING SYSTEM**

- Air conditioning/heating reverse cycle 336,000 BTU fan capacity with 288,000 BTU chiller capacity suitable for temperatures to 40°C (tropical)
- Windscreen demist facility
- Outlets in all areas

#### **WATER SYSTEM**

- Water tanks giving 1,865l capacity plus 205l hot water calorifier
- Automatic water pump with filter
- Water level gauge
- Deck filler
- Pump circuit breaker at main switch panel
- Electric freshwater toilet system linked to 720l holding tank, content gauge and low noise electric overboard discharge, with macerator backup system as well as dockside discharge system
- Grey water to take waste water from sinks/

shower, washing machine(s) and dishwasher

### **BILGE PUMPS**

- Automatic/manual override electric bilge pumps in engine room, rudder area, forward accommodation, crew area and anchor chain locker (10 in total)
- High capacity manual bilge system with suction points in the same areas
- Electric bilge pumps have controls and warning lights with audible alarm at helm position

### **FIRE EXTINGUISHERS**

- Automatic engine room fire extinguisher system (with manual override) and warning system at helm position providing automatic shutdown of engines, generators and ventilation fans
- Manually operated engine room air shutoff system
- Hand operated fire extinguishers in all guest cabins, galley, crew quarters and flybridge

### **OTHER STANDARD EQUIPMENT**

- Ensign staff
- Fenders (8)

- Mooring warps (4)
- First aid kit
- Set of towels (8 large, 8 hand) (10 sets for optional 5 cabin layout)
- Quilted bed covers supplied to all cabins (except crew cabin)
- Complete set of Lucrezia crystal glassware (8 settings consisting of tumbler, highball and wine glasses) (10 settings for optional 5 cabin layout)
- Set of Sous Le Soleil crockery (8 settings consisting of plate, cake plate, dessert plate, bowl, cup and saucer) (10 settings for optional 5 cabin layout)
- Set of stainless steel cutlery (8 settings of David Mellor "Paris" cutlery 7 pieces) (10 settings for optional 5 cabin layout)
- Tool kit
- Boat hook
- Owner's manual and engine manual
- Ship's document case
- Dynamat applied in the following locations
  - Crews aft engine room bulkhead
  - Crew deck head
  - Forward main deck owner's stateroom/dining area deck head

### **FINISHES**

- Teak-laid decks to all external deck areas (including flybridge)
- Timber flooring (V groove planked) to galley, skylounge, wheelhouse and forward dining area (wheelhouse in Newport oak as standard)
- Furniture in choice of Alba Oak, Rovere Oak in satin lacquer finish as standard. Silver Oak or Walnut with satin or gloss lacquer finishes available as an option
- Marble, quartz or granite floors in all bathroom suites in guest accommodation (including day head)
- Thermo-formed solid surface wash hand basin counter-tops in all bathroom suites and day head
- Galley counter top in granite or quartz as standard (some options carry additional premiums)
- Choice of high quality carpets and fabrics from extensive range
- Curtains, blinds or sunscreens to all windows and portholes (excludes pantograph doors and wheelhouse)
- Crew cabins have fitted carpet
- Crew bathrooms have solid surface floors and

countertops

- Non-slip safety flooring to crew mess and passageway